

ABERNATHY and ASSOCIATES

Kenneth B. Abernathy Jr.

Wisconsin Registered Land Surveyor S-1594

Rt. 3, Box 273  
Elkhorn, Wisconsin 53121  
Phone: (414) 723-4260 (office)  
(414) 723-7209 (FAX)

PLAT OF SURVEY

Lot 26 of Urbandale, a subdivision located in the Southeast 1/4 & Southwest 1/4 of the Northwest 1/4, and the Southwest 1/4 of the Northeast 1/4, all in Section 1, Town 2 North, Range 16 East, City of Elkhorn, Walworth County, Wisconsin

Unplatted  
Lands

Lot  
19

Lot  
27

Lot  
26  
34778 Sq. Ft.

Lot  
20

Davis  
Court

Lot  
25

EXISTING  
DWELLING  
(UNDER CONSTRUCTION)

Legend

- FOUND IRON PIPE
- FOUND IRON ROD
- FOUND BRASS CAPPED MONUMENT
- FOUND CONCRETE MONUMENT
- CHISEL CUT IN CONCRETE
- SET IRON ROD, 24" LONG, WEIGHING 1.5 LBS./LINEAL FT., 3/4" DIA.
- SET IRON ROD, 30" LONG, WEIGHING 4.5 LBS./LINEAL FT., 1-11/16" DIA.
- RECORDED AS DIMENSION
- EXISTING FENCE

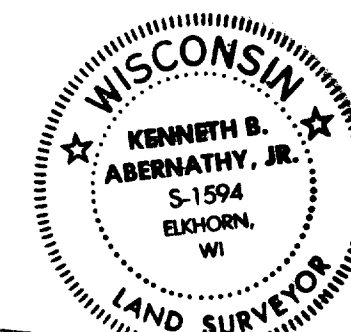

SCALE: 1"=20 FEET

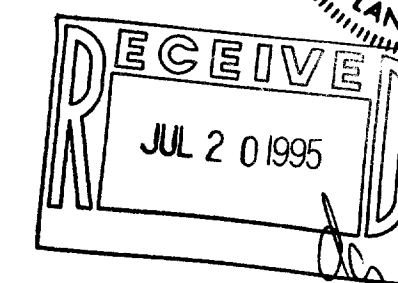

Ordered by: Thelen Total Construction, Inc.  
Post Office Box 17  
Elkhorn, Wisconsin

53121-0017

"I hereby certify that the above described property has been surveyed by me or under my direction and that the above map is a true representation thereof and shows the size and location of the property, its exterior boundaries, the location of all visible structures and dimensions of all principal buildings thereon, boundary fences, apparent easements, roadways and visible encroachments, if any."

"This survey is made for the use of the present owners of the property, and also those who purchase, mortgage, or guarantee the title thereto within one year from date hereof."

Kenneth B. Abernathy, Jr.  
KENNETH B. ABERNATHY, JR.  
WISCONSIN REGISTERED LAND SURVEYOR,  
S-1594

Date: May 11, 1995 Job No. 1995.401AB

004-944